

Frézy úhlové

Inverted dovetail milling cutters

Winkelstirnfräser

Фрезы одноугловые



3500

DIN 1835A

DIN 1835B

DIN 1833B

DIN 1833D

$\lambda=0^\circ$
 $\gamma=0^\circ$



HSS
Co5

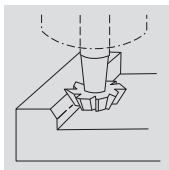
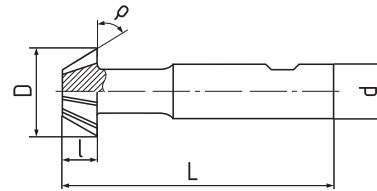

DIN 1835A

DIN 1835B

ρ ± 30	D js 16	l js 14	L	d h 6	Z	CODE	CODE
45°	16	4	60	12	10	350005.045160	350015.045160
45°	20	5	63	12	10	350005.045200	350015.045200
45°	25	6,3	67	12	10	350005.045250	350015.045250
45°	32	8	71	16	12	–	350015.045320
50°	16	5	60	12	12	–	350015.050160
50°	20	6,3	63	12	12	–	350015.050200
50°	25	8	67	12	12	–	350015.050250
55°	16	5,6	60	12	10	–	350015.055160
55°	20	7,1	63	12	10	–	350015.055200
55°	25	9	67	12	12	–	350015.055250
60°	16	6,3	60	12	10	350005.060160	350015.060160
60°	20	8	63	12	10	350005.060200	350015.060200
60°	25	10	67	12	10	350005.060250	350015.060250
60°	32	12,5	71	16	12	–	350015.060320
*65°	16	6,3	60	12	10	–	350015.065160
*65°	25	10	67	12	12	–	350015.065250
*70°	16	7	60	12	10	350005.070160	350015.070160
*70°	20	9	63	12	10	350005.070200	350015.070200
*70°	25	11	67	16	10	350005.070250	350015.070250
*75°	16	8	60	12	10	–	350015.075160
*75°	25	10	67	12	12	–	350015.075250

- 1
- 2
- 3**
- 4
- 5
- 6
- 7
- 8